



**STUART
CHARLES**
ESTATE AGENTS



Pen Green Lane

, Corby, NN17 1BL

£230,000



Pen Green Lane

, Corby, NN17 1BL

£230,000



Entrance Hall.

With staircase to first floor, doors to Kitchen and bedroom one and two.

Low level cistern with hand basin.

Kitchen

12'0" x 10'2" (3.66m x 3.11)

Fully fitted kitchen with both base level and eye level units.

Window to front elevation.

Bedroom one.

13'2 x 12 (4.01m x 3.66m)

fully independent bedroom currently let, window and radiator.

Bedroom Two.

10'2 x 9'10 (3.10m x 3.00m)

Full serviceable bedroom room to let, window and radiator.

First floor landing

Bedroom Three

13'8 x 12'2 (4.17m x 3.71m)

Fully serviceable room that is currently fully let, window and radiator.

Bedroom Four.

10'2 x 9'10 (3.10m x 3.00m)

Fully let bedroom, window and radiator.

Bedroom Five

10'2 x 8'2 (3.10m x 2.49m)

Fully let bedroom with radiator and window.

Shower room.

Fully fitted shower room with low level cistern and hand basin.

First floor WC.



Road Map



Hybrid Map



Terrain Map



Floor Plan

72 PEN GREEN LANE

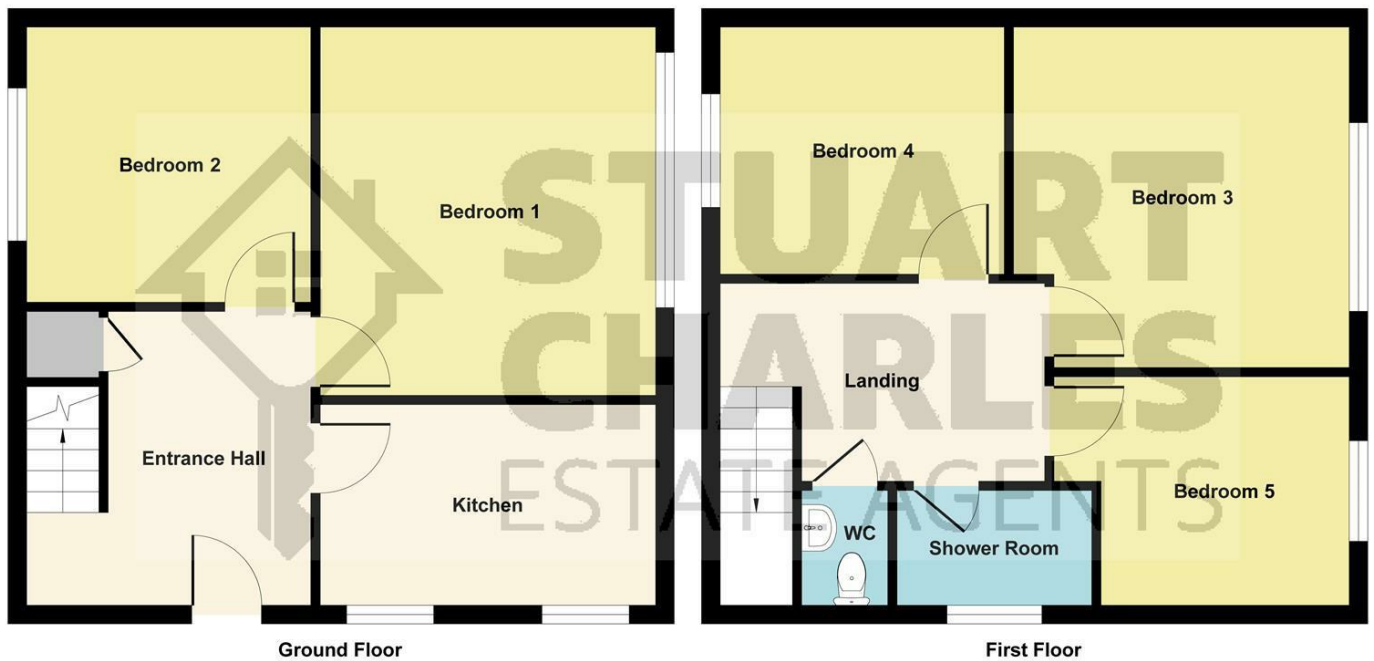
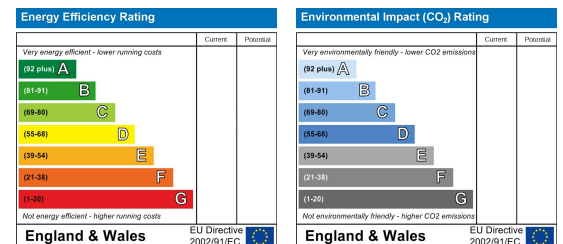

Illustration for identification purposes only, measurements are approximate, not to scale.
Produced by Elements Property

Viewing

Please contact our Stuart Charles Estate Agents Office on 01536 234264 if you wish to arrange a viewing appointment for this property or require further information.

Energy Efficiency Graph



These particulars, whilst believed to be accurate are set out as a general outline only for guidance and do not constitute any part of an offer or contract. Intending purchasers should not rely on them as statements of representation of fact, but must satisfy themselves by inspection or otherwise as to their accuracy. No person in this firm's employment has the authority to make or give any representation or warranty in respect of the property.