



27 Flatford Close, Corby, NN18 8PU



**STUART  
CHARLES**  
ESTATE AGENTS



**£157,500**

Stuart Charles are delighted to offer FOR SALE with NO CHAIN this two bedroom GROUND floor apartment located in the popular Oakleyvale area. Situated a short walk from mains bus links, schools and shops an early viewing is recommended to avoid missing out on this home. The accomodation comprises of a large hall, two bedrooms, three piece bathroom and a large open plan lounge/kitchen/diner. Outside is a low maintenance garden with gated access to the front. An off road parking space is located to the front of the home. Call now to view!!.

- NO CHAIN
- THREE PIECE BATHROOM
- GARDEN
- WALKING DISTANCE TO MAINS BUS
- CLOSE TO SCHOOLS
- TWO BEDROOMS
- OPEN PLAN LOUNGE/KITCHRN/DINER
- OFF ROAD PARKING SPACE
- CLOSE TO SHOPS

### Entrance Hall

Entered via a double glazed door, radiator, storage cupboard, doors to:

### Kitchen

12'3 x 11'5 (3.73m x 3.48m)

Fitted to comprise a range of base and eye level units with a single sink and drainer, gas hob with extractor, electric oven, space for free standing fridge/freezer, space for automatic washing machine, wall mounted boiler, double glazed window to rear elevation.

### Living Room

21'5 x 11'11 (6.53m x 3.63m)

Radiator, double glazed French doors to rear.

### Bedroom One

13'2 x 10'7 (4.01m x 3.23m)

Double glazed window to front elevation, radiator, tv point.













### **Bedroom Two**

11'10 x 8'9 (3.61m x 2.67m)

Double glazed window to front elevation, radiator.

### **Bathroom**

8'9 x 6'1 (2.67m x 1.85m)

Fitted to comprise a three piece suite consisting of a panel bath with shower over, low level wash hand basin, low level pedestal, radiator, double glazed window to front elevation.

### **Outside**

Rear A patio area leads onto a low maintenance garden, gated access is located to the rear.

Off road parking is located to the front.

























## Ground Floor

Approx. 70.8 sq. metres (761.6 sq. feet)

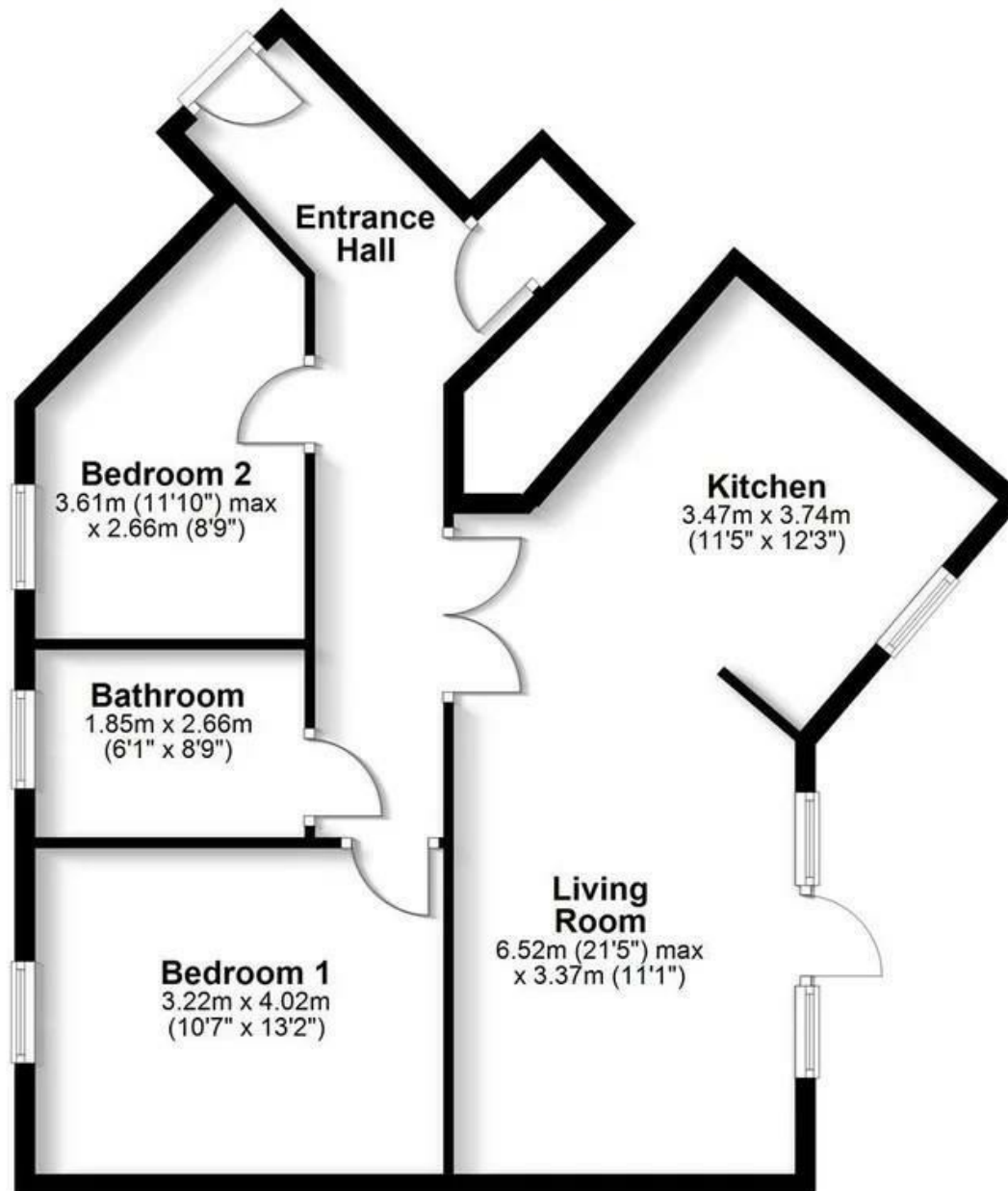

Total area: approx. 70.8 sq. metres (761.6 sq. feet)



