



59 Inwood Close, Corby, NN18 8LG



**£269,950**

Stuart Charles are delighted to offer for sale this three bedroom detached family home located in the in demand area of Oakley Vale. Positioned in a quiet cul de sac and within walking distance of several amenities to include schools and shops an early viewing is recommended to avoid missing out on this home. The accommodation to the ground floor of an entrance hall, guest WC, lounge/diner and kitchen. To the first floor are three good sized bedrooms and a three piece modern family bathroom. Outside to the front a driveway provides off road parking for multiple vehicles and leads to a garage. To the rear a small patio area leads onto a laid lawn and is enclosed by timber fencing to all sides, gated access is provided to the front. Call now to view!!

- REFITTED KITCHEN
- LARGE SOUTH FACING REAR GARDEN
- WELL PRESENT THROUGHOUT
- CLOSE TO LOCAL SCHOOLS
- DOWNSTAIRS WC
- GARAGE AND DRIVEWAY
- WALKING DISTANCE TO SHOPS

### Entrance Hall

Entered via a double glazed door, radiator, stairs rising to first floor landing, doors to:

### Guest W.C

### Kitchen

9'2 x 8 (2.79m x 2.44m)

Fitted to comprise a range of base and eye level units with a single sink and drainer, gas hob with extractor, electric

oven, space for fridge/freezer, space for automatic washing machine, radiator, double glazed window to front elevation.

### Lounge/Diner

14'7 x 14'7 (4.45m x 4.45m)

Double glazed window to rear elevation, double glazed French doors to rear elevation, radiator, tv point, telephone point.













## First Floor Landing

Loft access.

## Bedroom One

14'7 x 8'3 (4.45m x 2.51m)

Double glazed window to rear, radiator, tv point.

## Bedroom Two

9'10 x 6'9 (3.00m x 2.06m)

Double glazed window to rear elevation, radiator.

## Bedroom Three

7'8 x 6'7 (2.34m x 2.01m)

Double glazed window to rear elevation, radiator.









## Bathroom

5'7" x 5'6" (1.72m x 1.68m)

Fitted to comprise a three piece suite consisting of a panel bath with shower over, low level wash hand basin, low level pedestal, radiator, double glazed window to side elevation.

## Outside

















## Ground Floor

Approx. 351.1 sq. feet



## First Floor

Approx. 351.1 sq. feet

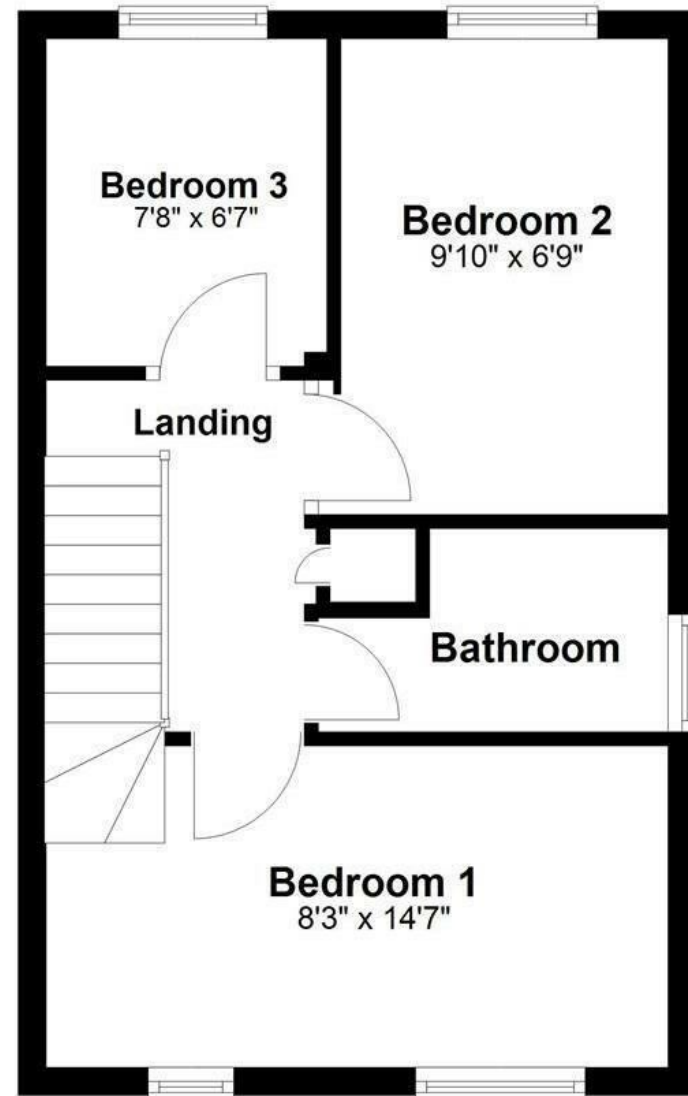

Total area: approx. 702.3 sq. feet



