



55 Counts Farm Road, Corby, NN18 8BJ



## Offers in the region of £180,000

Stuart Charles are delighted to offer for sale this TWO DOUBLE bedroom home located in the Town centre area of Corby. Situated a short walk away from a host of amenities an early and early viewing is recommended to avoid missing out on this home. The accommodation comprises to the ground floor of an entrance hall, open plan kitchen/diner and lounge. To the first floor are two double bedrooms and a three piece bathroom. Outside to the front is a laid lawn with picket fence surround, while to the rear a patio area that leads onto a laid lawn with brick built shed. It is enclosed by timber fence surround. Call now to view!!

- OPEN PLAN AREA
- NEW COMBI BOILER
- NEW BATHROOM
- NEW FLOORING THROUGHOUT
- TWO DOUBLE BEDROOMS
- REFITED KITCHEN
- CLOSE TO TOWN CENTRE
- READY TO MOVE INTO

### Entrance Hall

Entered via a double glazed door, radiator, under stairs storage, doors to:

### Lounge

13'2 x 10'7 (4.01m x 3.23m)

Double glazed window to front elevation, Tv point, radiator, space for electric fire.

### Kitchen/Diner

16'9 x 7'11 (5.11m x 2.41m)

Fitted to comprise a range of base and eye level units with a sink and drainer, hob with extractor, electric oven, space for automatic washing machine, space for free standing fridge/freezer, breakfast bar, radiator, built in pantry cupboard, double glazed window to rear elevation, double glazed door to rear elevation.













## Landing

Loft access, doors to:

## Bedroom One

13'7 x 9 (4.14m x 2.74m)

Double glazed window to front elevation, radiator, tv point, built in wardrobe, airing cupboard.

## Bedroom Two

10'6 x 10'4 (3.20m x 3.15m)

Double glazed window to rear elevation, radiator.









## Bathroom

5'11 x 5'6 (1.80m x 1.68m)

Fitted to comprise a three piece suite featuring a bath with shower over, low level pedestal, low level wash hand basin, extractor, radiator, double glazed window to rear elevation.

## Outside

To the front is a laid lawn with picket fence surround.

To the rear is a patio area that leads onto a laid lawn with brick built shed. It is enclosed by timber fence surround.

















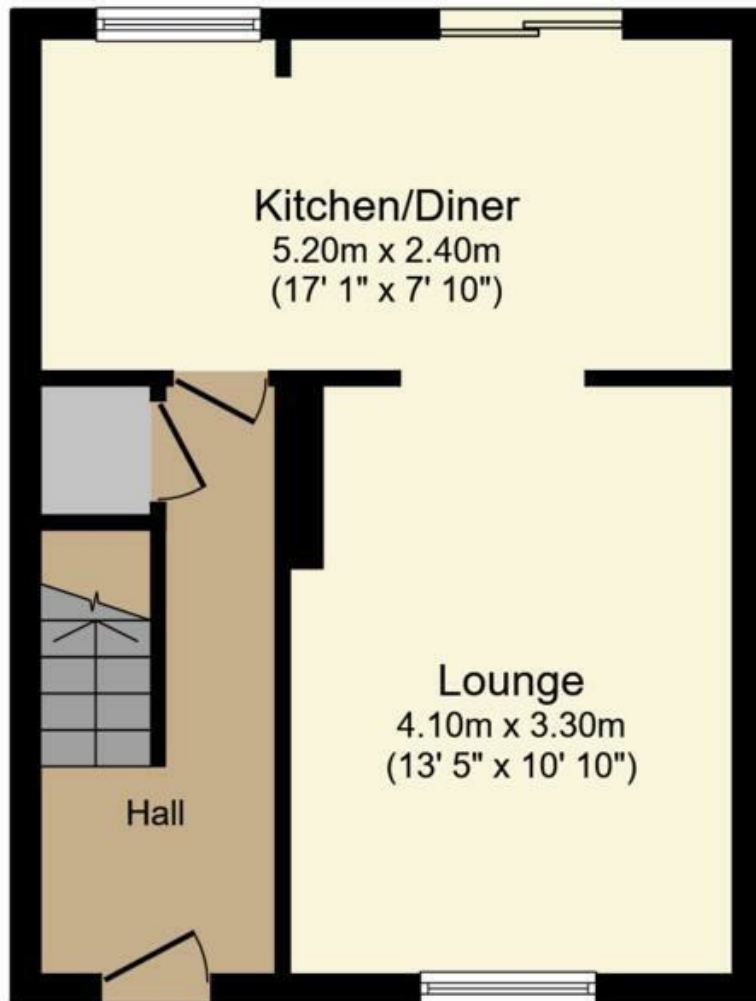

## Ground Floor

Floor area 33.8 m<sup>2</sup> (363 sq.ft.)

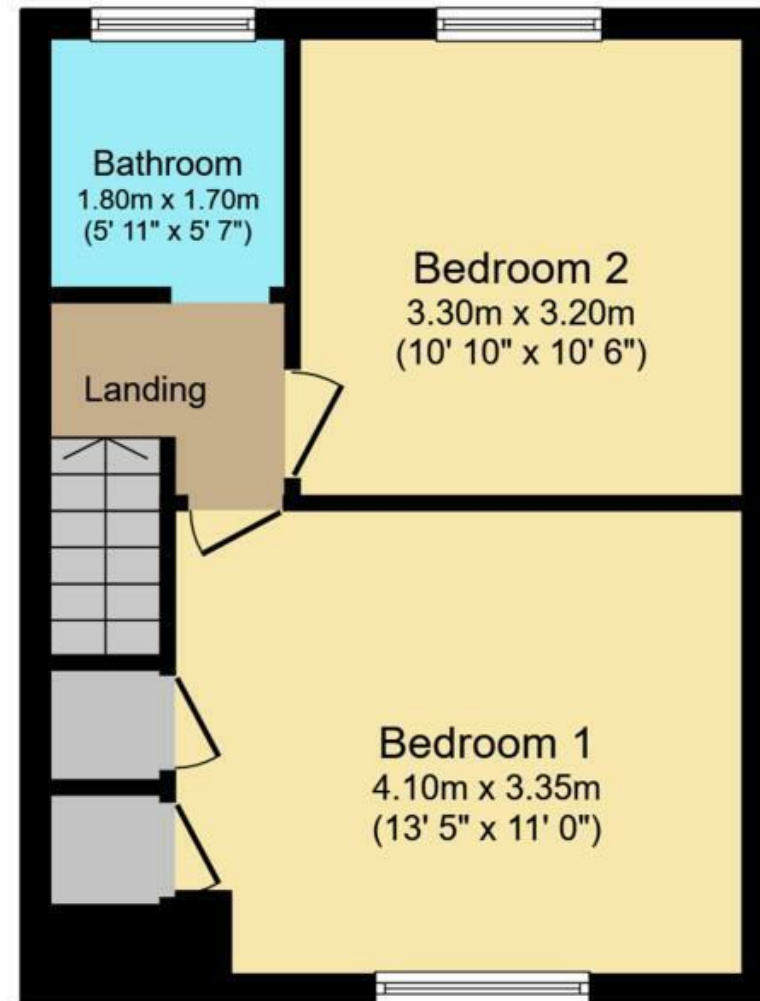

## First Floor

Floor area 33.7 m<sup>2</sup> (363 sq.ft.)

**TOTAL: 67.5 m<sup>2</sup> (726 sq.ft.)**

This floor plan is for illustrative purposes only. It is not drawn to scale. Any measurements, floor areas (including any total floor area), openings and orientations are approximate. No details are guaranteed, they cannot be relied upon for any purpose and do not form any part of any agreement. No liability is taken for any error, omission or misstatement. A party must rely upon its own inspection(s). Powered by [www.Propertybox.io](http://www.Propertybox.io)



